

位置公差			
J. G.	W. E.	J. B.	一般穴, M
±0.001	±0.002	±0.02	±0.2

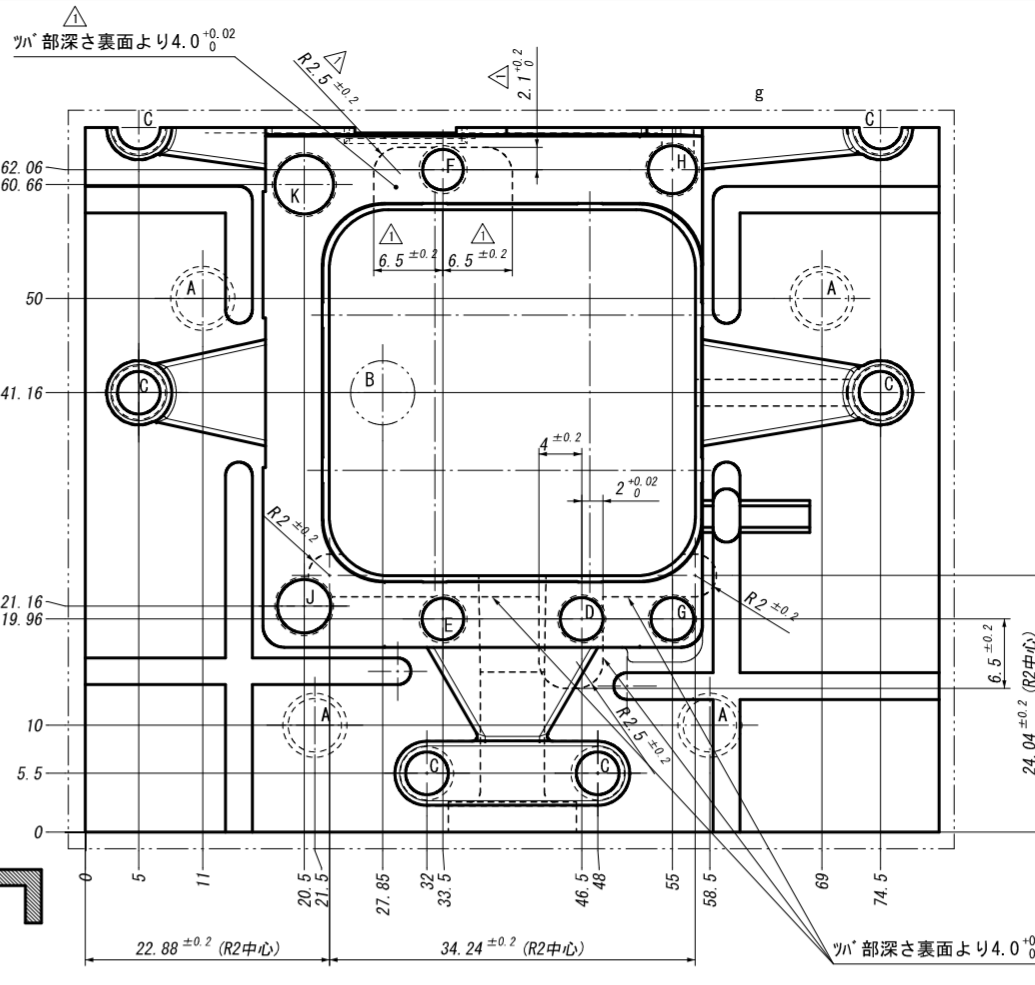

- A: 4-TAP6X16 (B)
- B: 1-6 (WE原点)
- C: 6-4 ±0.01, 5X54 (B)
- D: 1-4 ±0.005, 4.5X55 (B)
- E: 1-3.9 ±0.005, 4.5X55 (B)
- F: 1-3.8 ±0.005, 4.5X50 (B)
- G: 1-4 ±0.005, 4.5X55 (B)
- H: 1-4.5 ±0.005, 5X50 (B)
- J: 1-5 ±0.005, 5.5X55 (B)
- K: 1-5.5 ±0.005, 6X50 (B)
- L: 1-4 (WE原点)

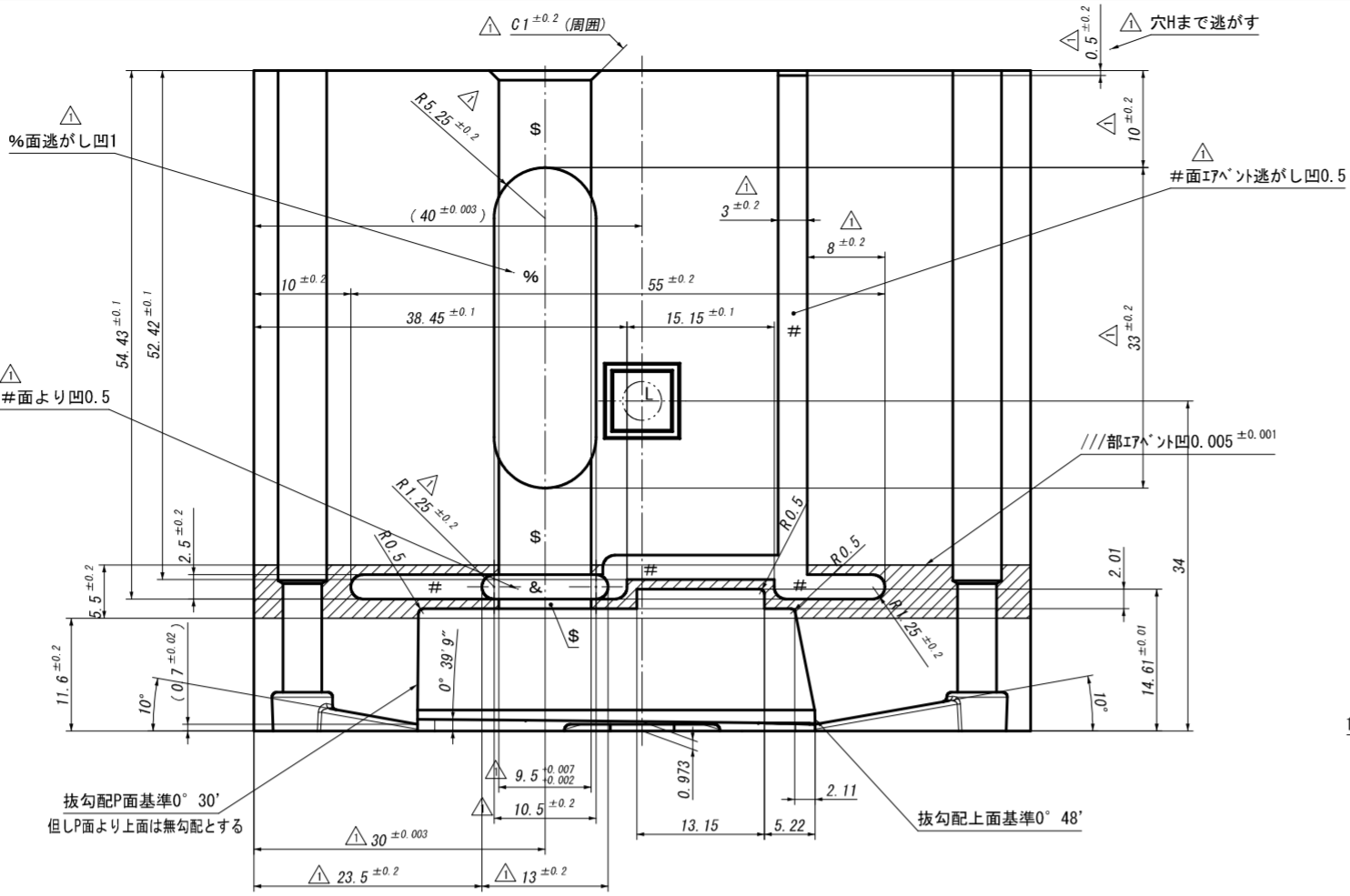
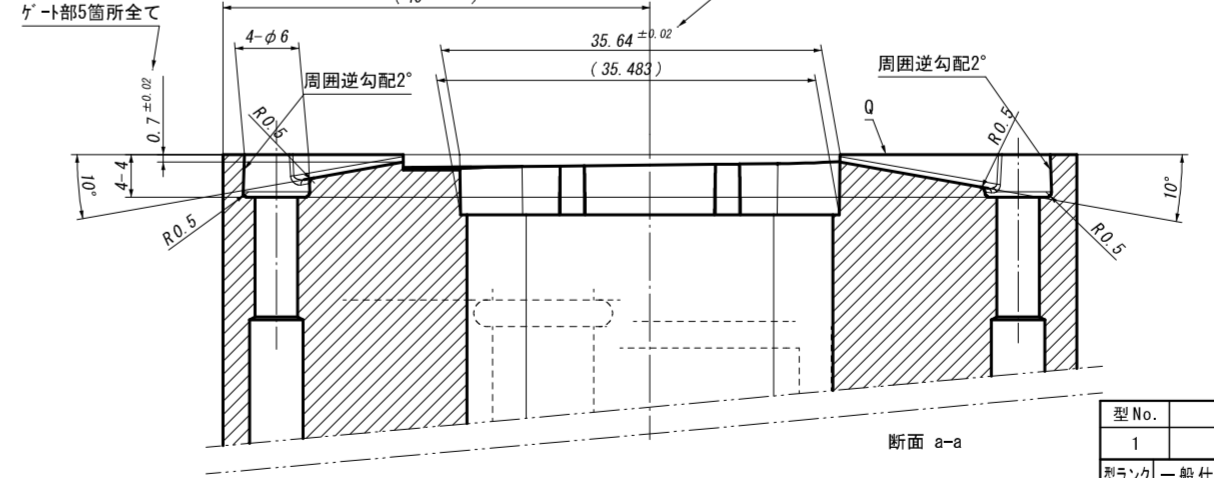
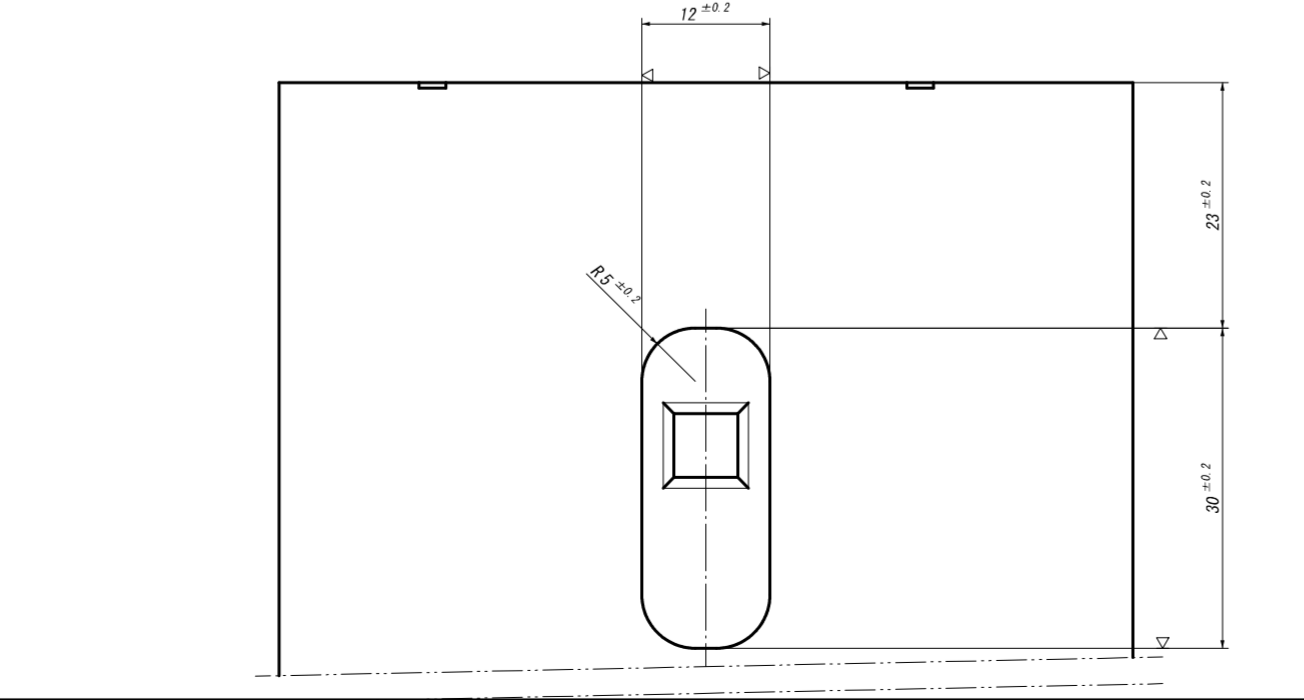
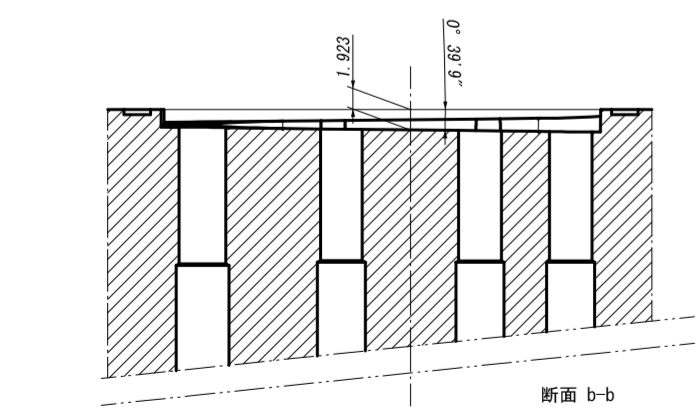
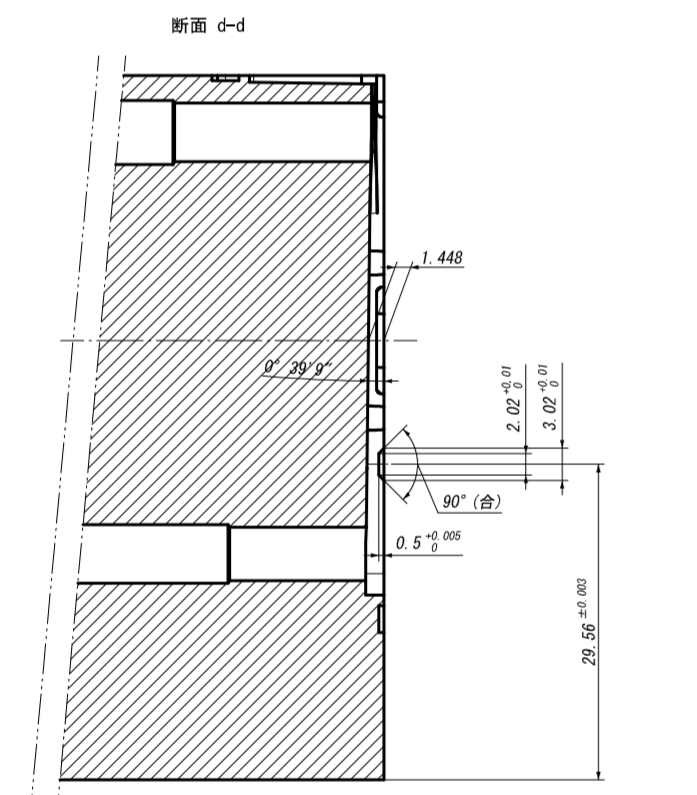
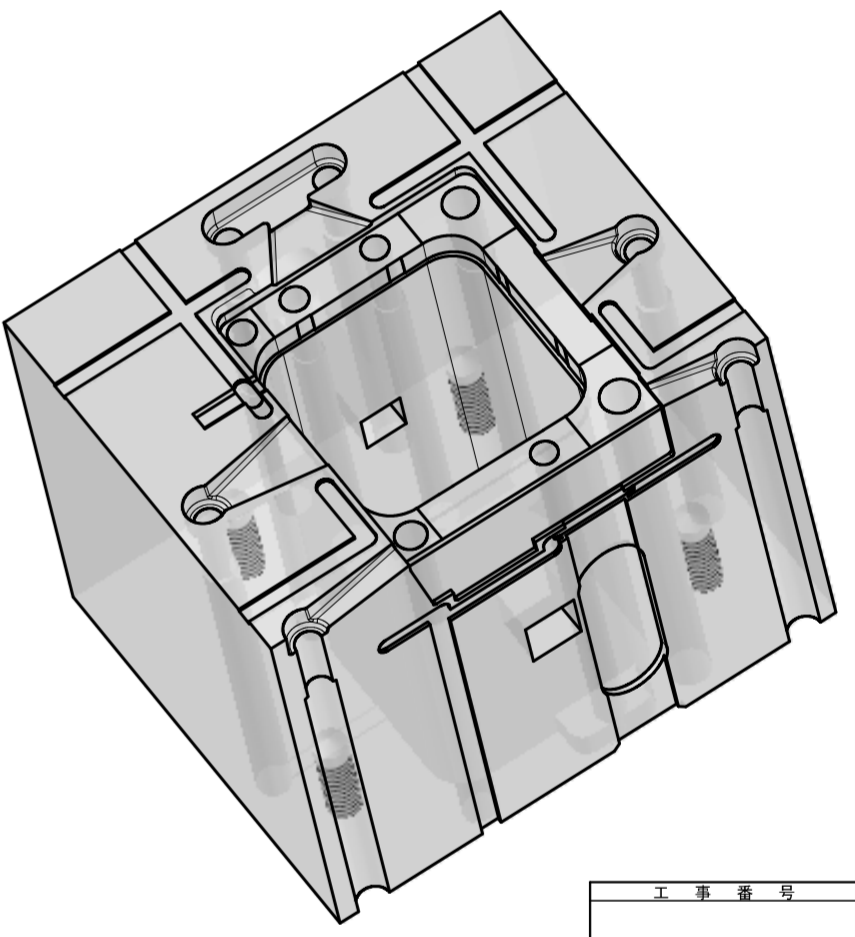
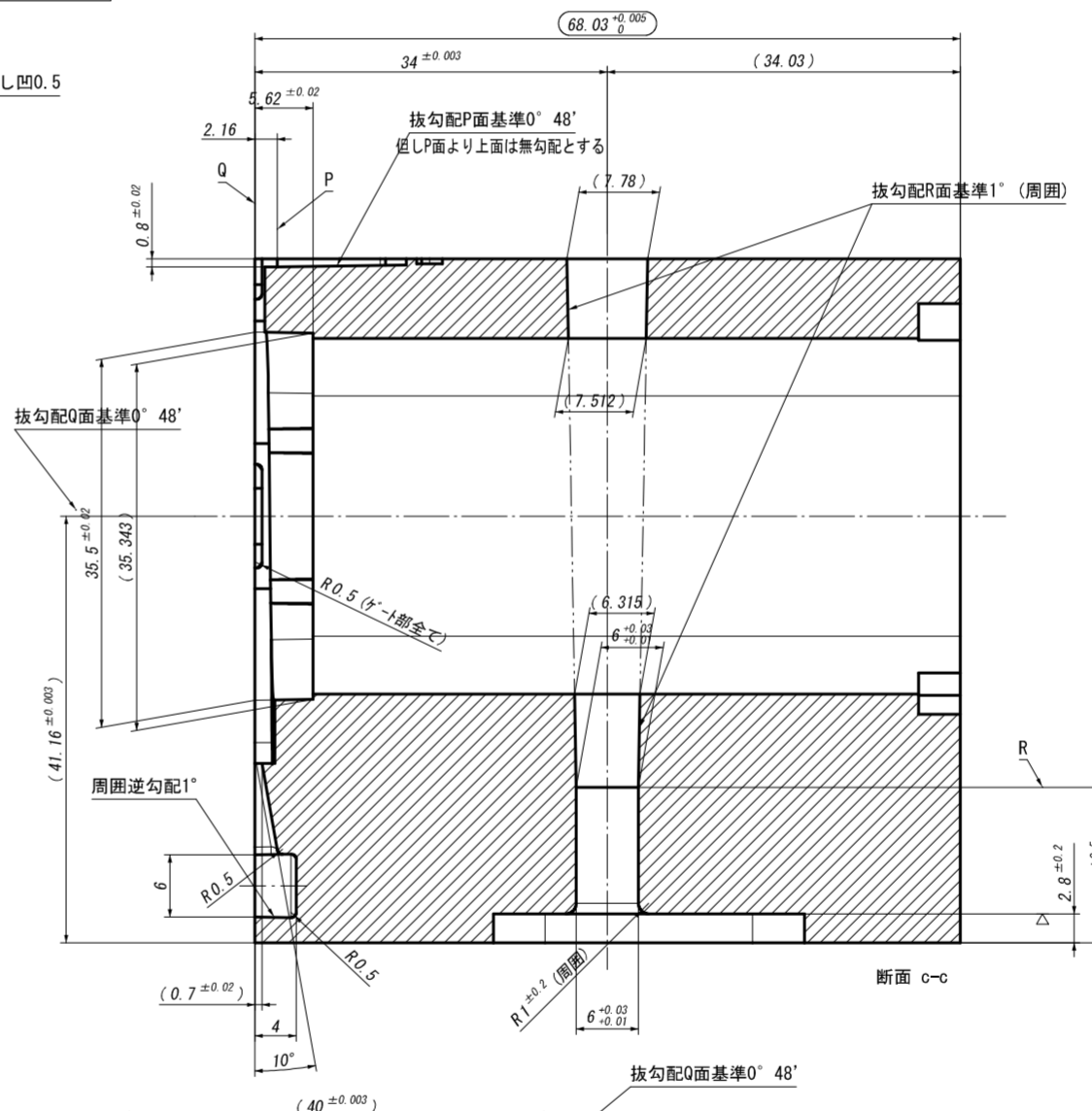
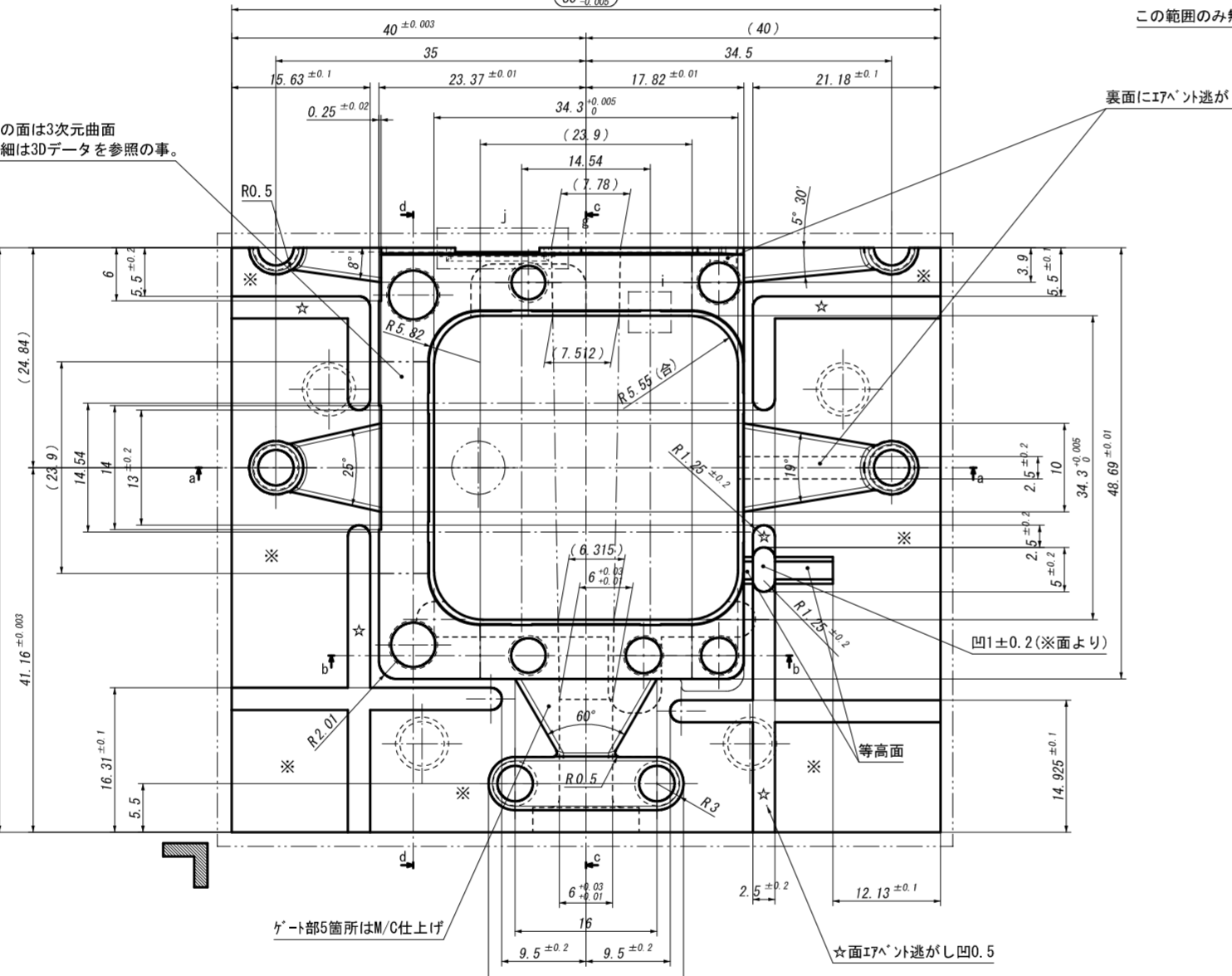
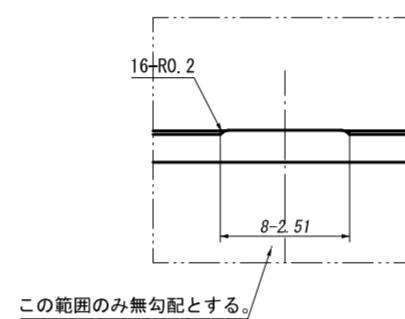
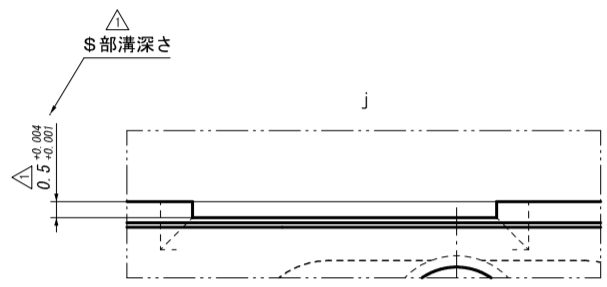

寸法未記入部個所はCADデータに参照する事。

工事番号				
日程表				
工程	見検工程	予定納期	加工者	

型No.	管理No.	△	-	-	-
1					
型No.の一般仕上一般公差					
A	1.6	±0.03			
品番	部品名	材質	硬度(HRC)	熱処理	個数
31	COR1	SKD11	58~60	T-G(JB)	4
合計					2 : 1
名		図番		承認	
称		成形材料	71-hp615016	機	
					2012/03/02

(第3角図法) (JIS A1) (金型)